

# DOMINGUEZ

## TECHNOLOGY CENTER

# 72,063 SF

Available For Lease



Legacy Building<sup>SM</sup> 658.2

18560 S. Wilmington Ave., Rancho Dominguez, CA 90220

### VALUE ADVANTAGE

Potential merchandise processing fee savings with Foreign Trade Zone 202 activation

Master Planned Center

Close to Ports of Los Angeles, Long Beach and Los Angeles International Airport

Convenient access to the San Diego (405), Harbor (110), Long Beach (710), Artesia (91) and Terminal Island (103) Freeways.

Near Intermodal Container Transfer Facility

### SPECIFICATIONS

**BUILDING SIZE:** 72,063 SF

**OFFICE SIZE:** 4,063 SF

**LAND SIZE:** Part of Larger

**POTENTIAL POWER CAPACITY:**  
400 amps, 277/480 volts, 3 phase, 4 wire (expandable)

**WAREHOUSE LIGHTING:** LED with motion sensors

**SPRINKLER SYSTEM:** ESFR

**PARKING SPACES:** 82

**MINIMUM CLEARANCE:** 30'

**TURNING RADIUS:** Up to 135'

**DOCK HIGH TRUCK POSITIONS:** 11 - 9' x 10'

**GROUND LEVEL RAMP:** 1

**BAY SPACING:** 50' x 52' (Typical)  
60' at first loading bay



# DOMINGUEZ TECHNOLOGY CENTER

# 72,063 SF

Available For Lease



OFFICE PLAN 4,063 SF

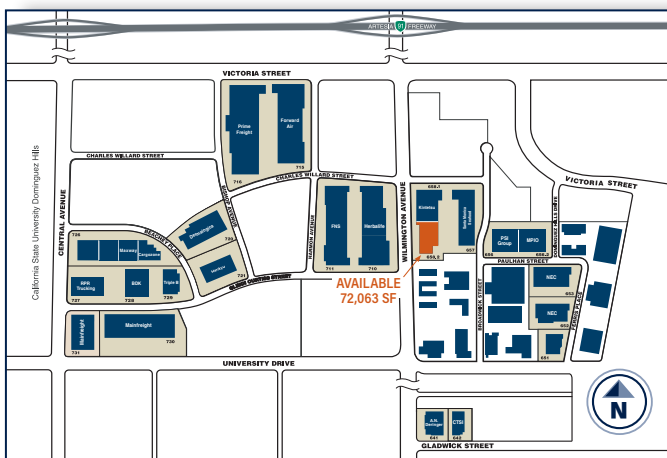
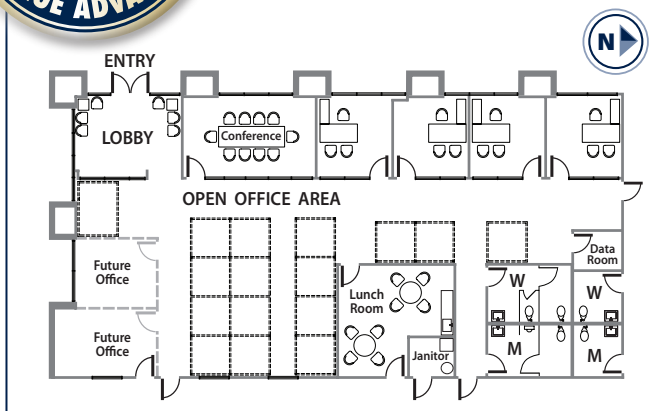

LEGACY BUILDING<sup>SM</sup> 658.2 SITE PLAN

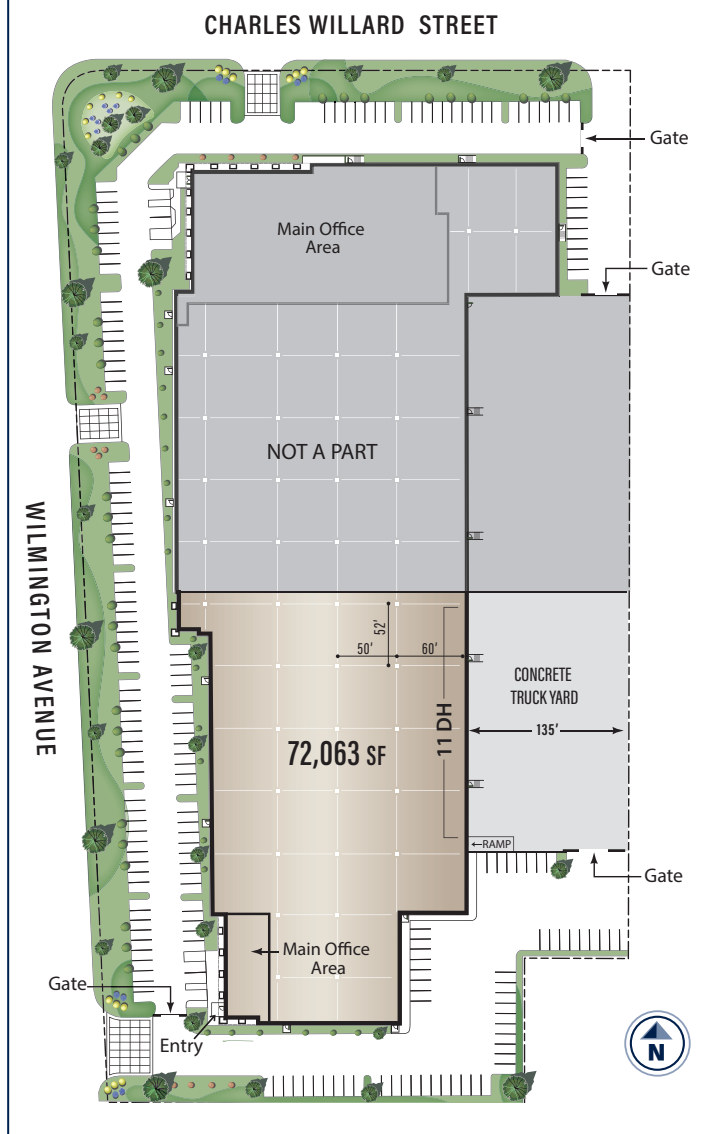

For Further Information Please Contact:

**Lance Ryan**  
lryan@watsonlandcompany.com

**Mike Bodlovich**  
mbodlovich@watsonlandcompany.com



The information on this brochure has been compiled for the internal administrative convenience of Watson Land Company. Watson Land Company makes no representation or warranty, express or implied, as to the accuracy of this brochure. This brochure may not reflect all building improvements or as-built conditions. The information contained herein and on any other materials with which it is presented is not an offer and is subject to change without notice. Tenants should make their own independent investigations of all facts and assumptions on which they might rely in making a decision to lease property from Watson Land Company.