

# WATSON

INDUSTRIAL CENTER

## 103,185 SF

Available For Lease

Overweight Corridor



Watson Building 155

989 E. 233rd. Street, Carson, CA 90745

### VALUE ADVANTAGE

Excess Yard Area

Potential merchandise processing fee savings with Foreign Trade Zone 202 activation

Master Planned Center

Close to Ports of Los Angeles, Long Beach and Los Angeles International Airport

Convenient access to the San Diego (405), Harbor (110), Long Beach (710), Artesia (91) and Terminal Island (103) Freeways.

Near Intermodal Container Transfer Facility

### SPECIFICATIONS

**BUILDING SIZE:** 103,185 SF

**OFFICE SIZE:** 4,811 SF

**LAND SIZE:** 195,791 SF

**POWER:** 1,200 amps, 277/480 volts, 3 phase, 4 wire

**WAREHOUSE LIGHTING:** T8

**SPRINKLER SYSTEM:** .54 GPM/3,000 SF

**PARKING SPACES:** 126

**MINIMUM CLEARANCE:** 24' 5"

**DOCK HIGH TRUCK POSITIONS:** 19  
(1 - 9'x 10' and 9 - 18'x 11')

**GROUND LEVEL RAMPS:** 3  
(1 - 12'x 14', 1 - 16'x 11' and 1 - 18'x 14')

**BAY SPACING:** 48'x 48' (Typical)



# WATSON

INDUSTRIAL CENTER

## 103,185 SF

Available For Lease



### OFFICE PLAN

4,811 SF Office

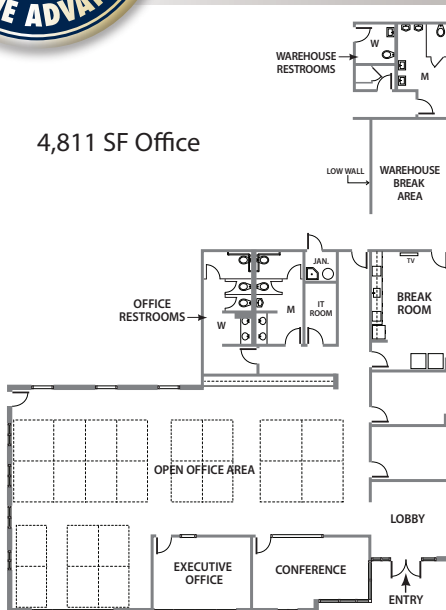

### WATSON BUILDING 155 SITE PLAN

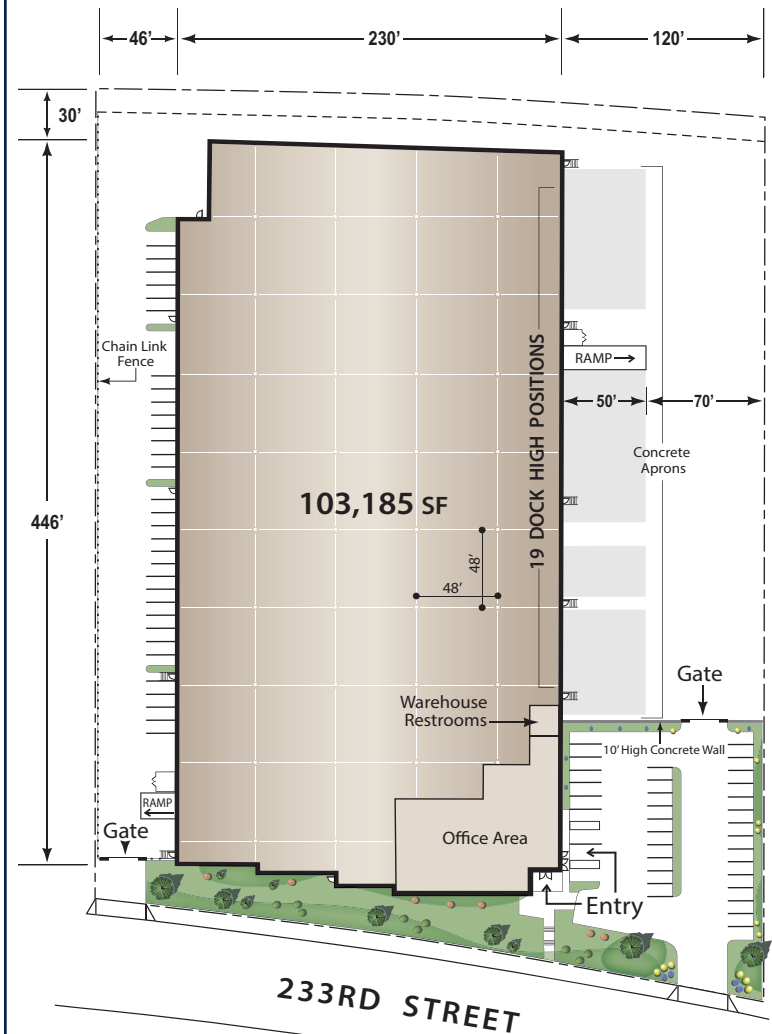

For Further Information Please Contact:

**Lance Ryan** lryan@watsonlandcompany.com

**Mike Bodlovich** mbodlovich@watsonlandcompany.com

The information on this brochure has been compiled for the internal administrative convenience of Watson Land Company. Watson Land Company makes no representation or warranty, express or implied, as to the accuracy of this brochure. This brochure may not reflect all building improvements or as-built conditions. The information contained herein and on any other materials with which it is presented is not an offer and is subject to change without notice. Tenants should make their own independent investigations of all facts and assumptions on which they might rely in making a decision to lease property from Watson Land Company.



WATSON LAND COMPANY 22010 Wilmington Avenue, Carson, California 90745

Phone 310.952.6417