

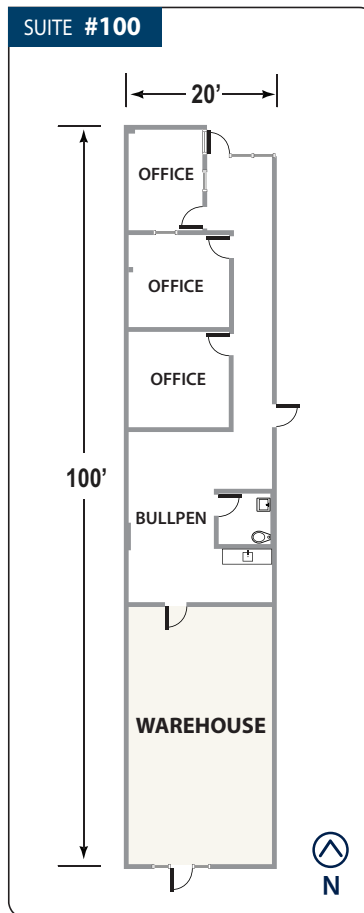

**> 4% Commission for a Referred Deal that is Completed**

Suite# / Location	Suite Size	Office Size	Comments	Lease Rate*	Date Available	Contact
<b>WATSON BUSINESS CENTER</b>		<b>CARSON</b>				
<b># 100</b> 1950 East 220th St.	2,000 SF	60% Approx. 1,200 SF	3 Private Offices, Open Bullpen Area, 1 Restroom and Warehouse	TBD	<b>Now</b>	Sarah Sabet



Warehouse

Contact: **Sarah Sabet** 310.952.6408 ssabet@watsonlandcompany.com

*\*Lease rate per square foot includes monthly rent, property taxes, property insurance, and common area maintenance*

The information contained herein and on any other materials with which it is presented is not an offer and is subject to change without notice. Tenants should make their own independent investigations on all facts and assumptions on which they might rely in making a decision to lease property from Watson Land Company. This statement is based upon current information, subject to availability and revisions at any time.



**> 4% Commission for a Referred Deal that is Completed**

Suite# / Location	Suite Size	Office Size	Comments	Lease Rate*	Date Available	Contact
<b>WATSON BUSINESS CENTER</b> CARSON (Long Beach P.O.)						
<b># 406</b> 21818 S. Wilmington Ave.	1,920 SF	20% Approx. 384 SF	1 Private Office, Reception Area, 1 Restroom, Millwork Cabinets and Sink in Warehouse	TBD	<b>Now</b>	Sarah Sabet
<b># 408</b> 21818 S. Wilmington Ave.	1,920 SF	50% Approx. 960 SF	1 Private Office, Large Bullpen Area, Reception Area, 1 Restroom and Warehouse	TBD	<b>Now</b>	Sarah Sabet
<b># 304</b> 21720 S. Wilmington Ave.	2,304 SF	45% Approx. 1,049 SF	1 Private Office, Large Bullpen Area, Reception Area, 1 Restroom and Warehouse	TBD	<b>Now</b>	Sarah Sabet
<b># 306</b> 21720 S. Wilmington Ave.	2,304 SF	18% Approx. 415 SF	1 Private Office, Reception Area, 1 Restroom and Warehouse	TBD	<b>Now</b>	Sarah Sabet

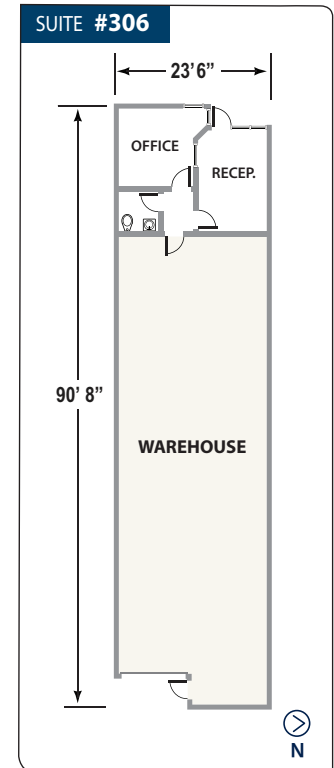
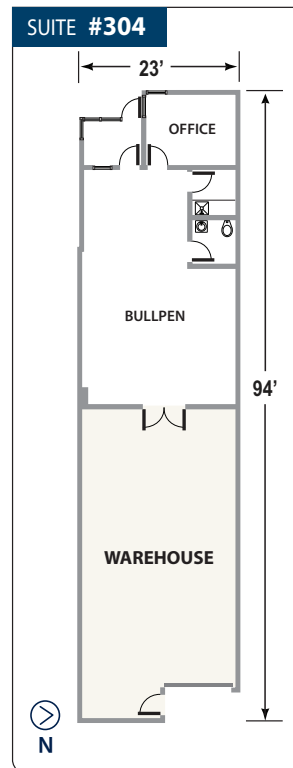
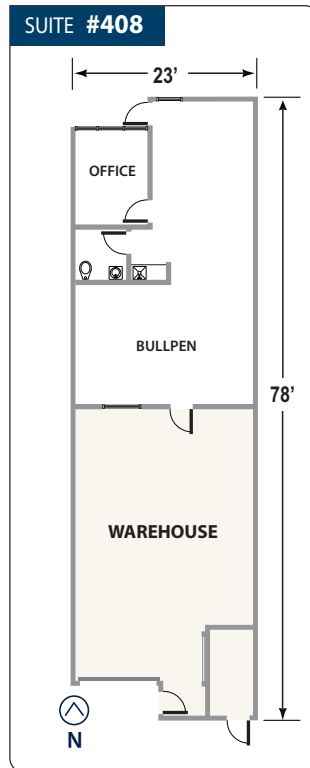
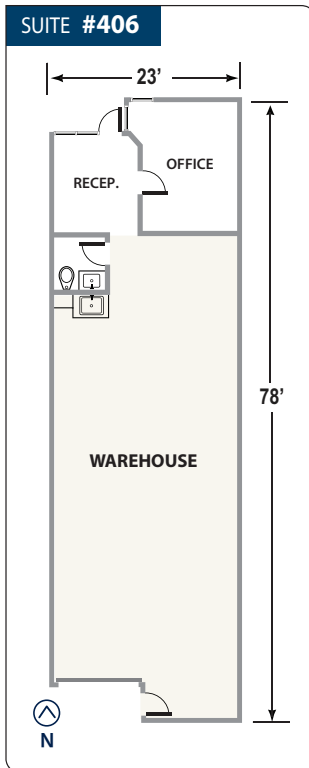

Warehouse

Contact: **Sarah Sabet** 310.952.6408 ssabet@watsonlandcompany.com

*\*Lease rate per square foot includes monthly rent, property taxes, property insurance, and common area maintenance*

The information contained herein and on any other materials with which it is presented is not an offer and is subject to change without notice. Tenants should make their own independent investigations on all facts and assumptions on which they might rely in making a decision to lease property from Watson Land Company. This statement is based upon current information, subject to availability and revisions at any time.



**> 4% Commission** for a Referred Deal that is Completed

Suite# / Location	Suite Size	Office Size	Comments	Lease Rate*	Date Available	Contact
<b>WATSON BUSINESS CENTER</b>		CARSON (Long Beach P.O.)				
<b># 414</b> 21818 S. Wilmington Ave.	5,760 SF	50% Approx. 2,880 SF	Several Private Offices, 1 Conference Room, Reception Area, 3 Restrooms and 2 Warehouses	TBD	<b>Now</b>	Sarah Sabet

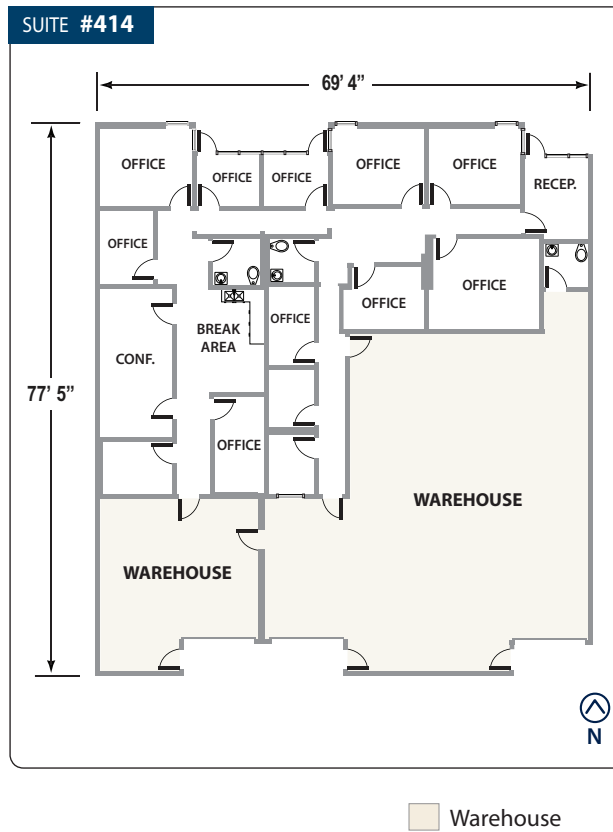

Contact: **Sarah Sabet** 310.952.6408 ssabet@watsonlandcompany.com

*\*Lease rate per square foot includes monthly rent, property taxes, property insurance, and common area maintenance*

The information contained herein and on any other materials with which it is presented is not an offer and is subject to change without notice. Tenants should make their own independent investigations on all facts and assumptions on which they might rely in making a decision to lease property from Watson Land Company. This statement is based upon current information, subject to availability and revisions at any time.

**WATSON BUSINESS CENTER - CARSON**

**31 SUITES 1,600 SF to 12,800 SF**



**WATSON LAND COMPANY**

22010 Wilmington Avenue  
Carson, California 90745

[watsonlandcompany.com](http://watsonlandcompany.com)

 Available Properties

April 2025



**Contact:**

**Sarah Sabet**

310.952.6408

[ssabet@watsonlandcompany.com](mailto:ssabet@watsonlandcompany.com)

**WATSON BUSINESS CENTER - LONG BEACH**

**35 SUITES 960 SF to 25,000 SF**

