

WATSON

COMMERCE CENTER

265,267 SF

Available For Lease

Best New Industrial Development - Awarded by the City of Chino



Build Green. Everyone Profits.

LEED- Leadership in Energy & Environmental Design

Legacy BuildingSM 818 has been constructed as an LEED[®] certified building. LEED[®] developments are voluntary and are designed to be environmentally responsible, high performing, sustainable and healthy places to work.

*LEED is a registered trademark of the U.S. Green Building Council.

Legacy BuildingSM 818 | 6911 Bickmore Avenue, Chino, CA 91710

SPECIFICATIONS

BUILDING SIZE: 265,267 SF

OFFICE SIZE: 8,460 SF (2 Offices)

LAND SIZE: 533,850

TRUCK POSITIONS: Dock high: 42 (9' x 10')
Ground level ramp: 2 (12' x 14')

TRUCK TURNING RADIUS: 187'

MINIMUM CLEARANCE: 32'

SPRINKLER SYSTEM: ESFR

POWER: 1200 amps, 480/277 volts,
3 phase, 4 wire

PARKING SPACES: 108 (Expandable)

LIGHTING: T-5 with motion sensors

LEGACY FEATURES

51 trailer storage spaces

Secure, fenced 100% concrete truck courts

3% skylights

Architectural two-story glass entries

7" thick reinforced, 4,000 psi
concrete floor slabs

Abundant clerestory glass

12 dock levelers in place

Approximately 4,000 SF of bonus storage
mezzanine (not included in SF)



Developed Owned and Managed by WATSON LAND COMPANY

watsonlandcompany.com

COMMERCE CENTER

265,267 SF

Available For Lease



OFFICE PLAN 4,230 SF

(2 offices totaling 8,460 SF)

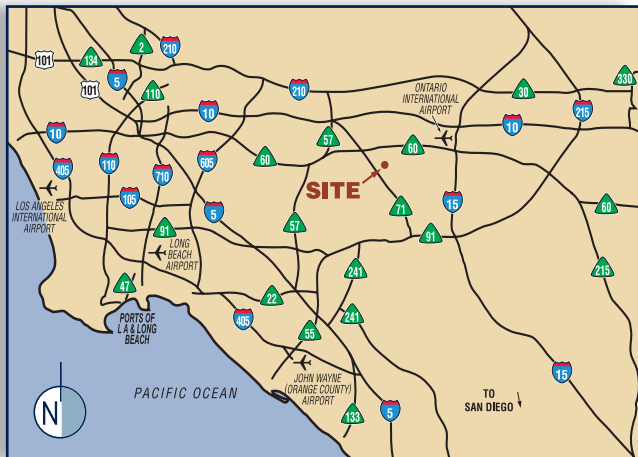
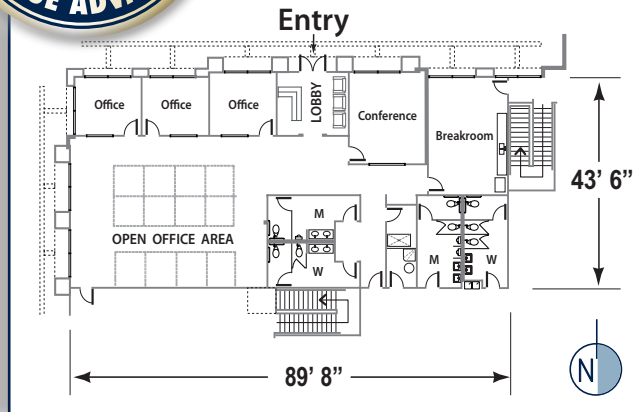

LEGACY BUILDINGSM 818 SITE PLAN

LEED® Certified

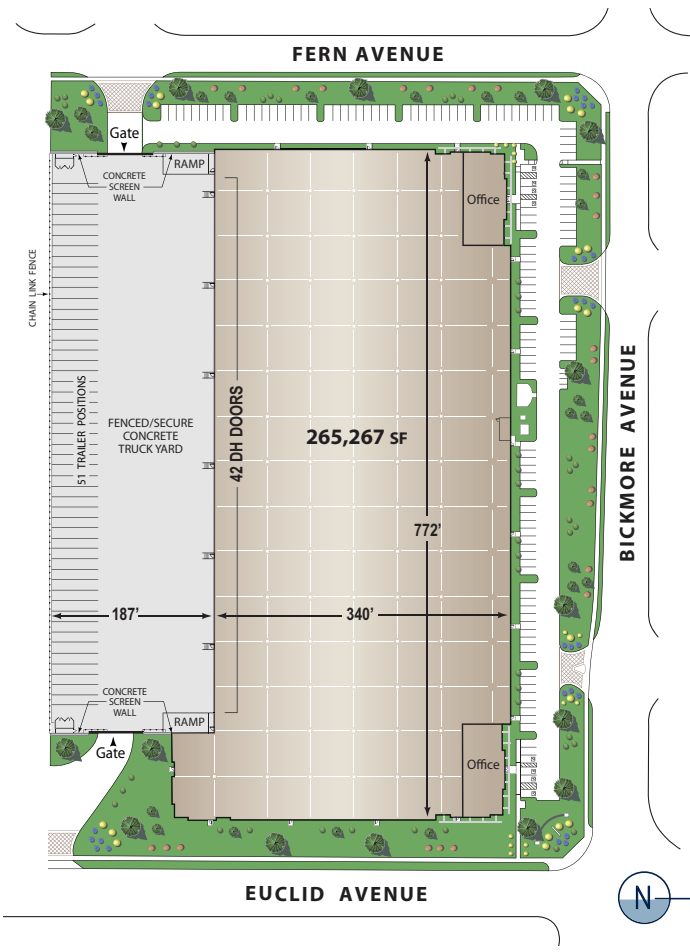

For Further Information Please Contact:

Thomas E. Taylor

Senior Executive Vice President | Inland Empire
Logistics & Transportation Solutions

thomas.taylor@colliers.com

CA License #00598896

Steven J. Bellitti

Senior Executive Vice President
Logistics & Transportation Solutions

steve.bellitti@colliers.com

CA License #01048797

Evelyn Manning

Vice President

evelyn.manning@colliers.com

CA License #02062838



Our *Knowledge* is your Property

COLLIERS International

2855 Guasti Road

Suite 401

Ontario, CA 91761

Ph 909.605 9400

www.colliers.com

The information on this brochure has been compiled for the internal administrative convenience of Watson Land Company. Watson Land Company makes no representation or warranty, express or implied, as to the accuracy of this brochure. This brochure may not reflect all building improvements or as-built conditions. The information contained herein and on any other materials with which it is presented is not an offer and is subject to change without notice. Tenants should make their own independent investigations of all facts and assumptions on which they might rely in making a decision to lease property from Watson Land Company.

Developed Owned and Managed by WATSON LAND COMPANY 22010 Wilmington Avenue, Carson, California 90745