

# DOMINGUEZ

## TECHNOLOGY CENTER

# 45,570 SF

Available For Lease



Legacy Building<sup>SM</sup> 642

1957 E. Gladwick Street, Rancho Dominguez, CA

### VALUE ADVANTAGE

Potential merchandise processing fee savings with Foreign Trade Zone 202 activation

Master Planned Center

Close to Ports of Los Angeles, Long Beach and Los Angeles International Airport

Convenient access to the San Diego (405), Harbor (110), Long Beach (710), Artesia (91) and Terminal Island (103) Freeways.

Near Intermodal Container Transfer Facility

### SPECIFICATIONS

**BUILDING SIZE:** 45,570 SF

**OFFICE SIZE:** 2,750 SF

**LAND SIZE:** 121,532

**POWER:** 800 amps, 277/480 volts, 3 phase, 4 wire

**WAREHOUSE LIGHTING:** LED

**SPRINKLER SYSTEM:** .60 GPM/3,000SF  
EFSR Ready

**PARKING SPACES:** 51

**MINIMUM CLEARANCE:** 30'

**TURNING RADIUS:** 135'

**DOCK HIGH TRUCK POSITIONS:** 15 - 9'x 10'

**GROUND LEVEL RAMP:** 1 - 12'x 14'

**BAY SPACING:** 50'x 52' (Typical)



# DOMINGUEZ TECHNOLOGY CENTER

**45,570SF**  
Available For Lease



**OFFICE PLAN 2,750 SF**

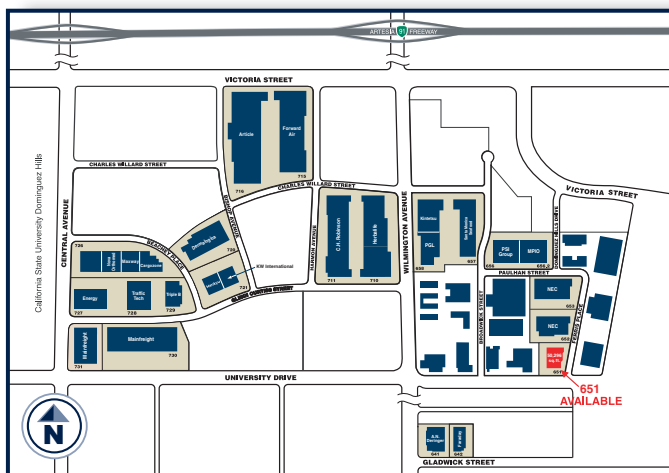
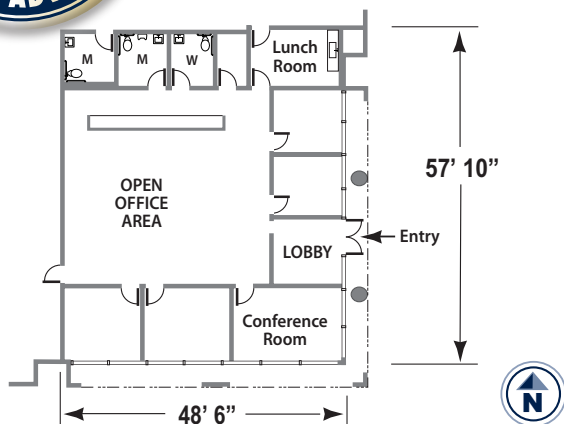

**WATSON BUILDING 642 SITE PLAN**

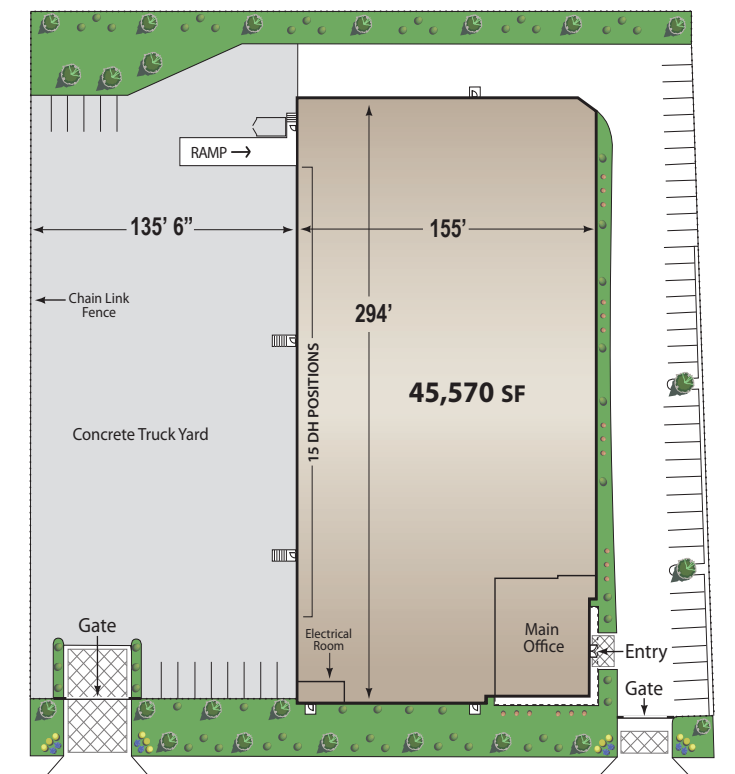

**EAST GLADWICK STREET**



The information on this brochure has been compiled for the internal administrative convenience of Watson Land Company. Watson Land Company makes no representation or warranty, express or implied, as to the accuracy of this brochure. This brochure may not reflect all building improvements or as-built conditions. The information contained herein and on any other materials with which it is presented is not an offer and is subject to change without notice. Tenants should make their own independent investigations of all facts and assumptions on which they might rely in making a decision to lease property from Watson Land Company.



For Further Information Please Contact:

**Lance Ryan**  
lryan@watsonlandcompany.com

**Mike Bodlovich**  
mbodlovich@watsonlandcompany.com

**Bridgette Sanossian**  
bsanossian@watsonlandcompany.com

**Phone 310.952.6401**

**Fax 310.522.8788**

