

# WATSON

COMMERCE CENTER

## 502,065 SF

Available For Lease



Build Green. Everyone Profits.

### LEED- Leadership in Energy & Environmental Design

Legacy Building<sup>SM</sup> 828 has been constructed as an LEED<sup>®</sup> certified building. LEED<sup>®</sup> developments are voluntary and are designed to be environmentally responsible, high performing, sustainable and healthy places to work.

\*LEED is a registered trademark of the U.S. Green Building Council.

## Legacy Building<sup>SM</sup> 828

15785 Mountain Avenue, Chino, CA

### SPECIFICATIONS

**BUILDING SIZE:** 502,065 SF

**OFFICE SIZE:** 5,235 SF

**LAND SIZE:** 1,067,969 SF

**TRUCK POSITIONS:** Dock High: 120 (9' x 10')  
Ground Level Ramp: 2 (12' x 14')

**TRUCK TURNING RADIUS:** 185'

**MINIMUM CLEARANCE:** 36'

**SPRINKLER SYSTEM:** ESFR

**POWER:** 1,200 amps, 480/277 volts,  
3 phase, 4 wire (Expandable)

**TRAILER STORAGE POSITIONS:** 165

**PARKING SPACES:** 224 (Expandable)

### LEGACY FEATURES

100% concrete truck courts

3% skylights

Architectural two-story glass entries

8" thick reinforced, 4,000 psi  
concrete floor slabs

Abundant clerestory glass



# WATSON

COMMERCE CENTER

## 502,065 SF

Available For Lease



OFFICE PLAN 5,235 SF

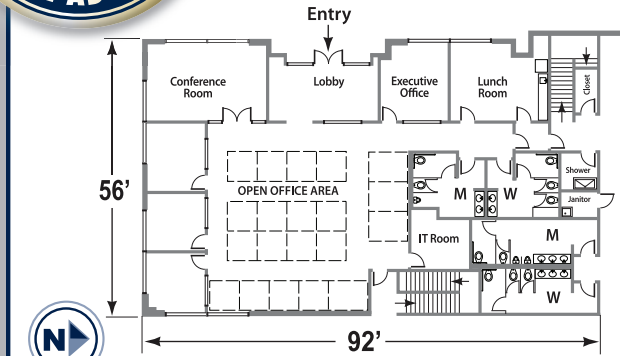

WATSON COMMERCE CENTER- CHINO

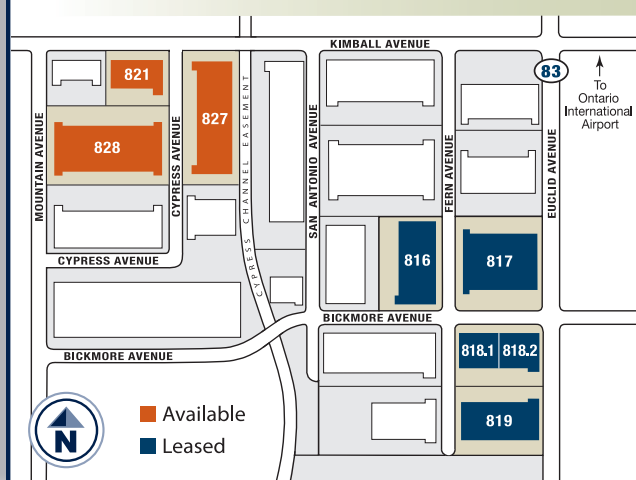

LEGACY BUILDING<sup>SM</sup> 828 SITE PLAN

LEED<sup>®</sup> Certified

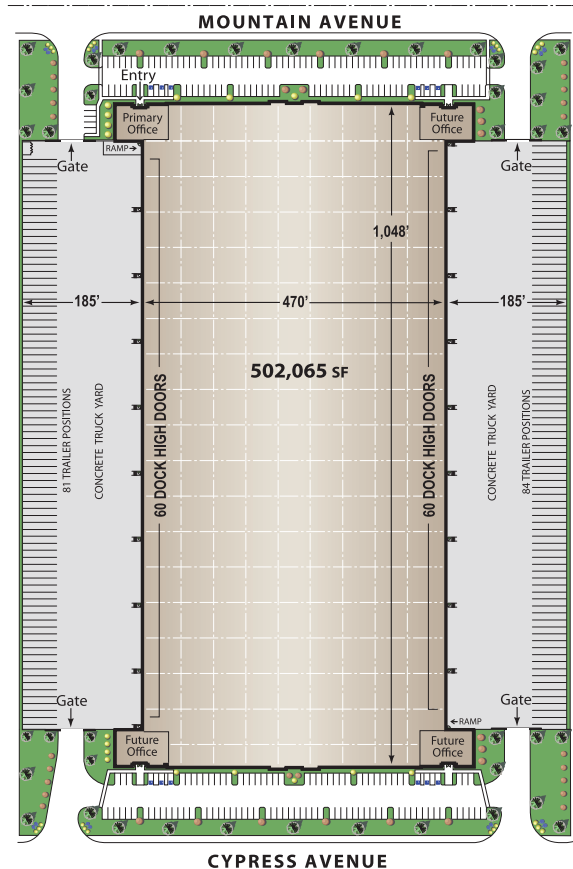

The information on this brochure has been compiled for the internal administrative convenience of Watson Land Company. Watson Land Company makes no representation or warranty, express or implied, as to the accuracy of this brochure. This brochure may not reflect all building improvements or as-built conditions. The information contained herein and on any other materials with which it is presented is not an offer and is subject to change without notice. Tenants should make their own independent investigations of all facts and assumptions on which they might rely in making a decision to lease property from Watson Land Company.

For Further Information Please Contact:

**Steven J. Bellitti**  
steve.bellitti@colliers.com  
License # 01048797

**Thomas E. Taylor**  
thomas.taylor@colliers.com  
License # 00598896

**Josh Hayes**  
josh.hayes@colliers.com  
License # 01300731

**Summer Coulter**  
summer.coulter@colliers.com  
License # 01811350

Ph 909.605.9400 Fax 909.396.4300



Our Knowledge is your Property

**COLLIERS International**  
2855 E. Guasti Road  
Suite 401  
Ontario, CA 91761  
colliers.com

watsonchino.com

