

WATSON

INDUSTRIAL PARK CHINO

565,925 SF

Available For Lease

36' Clear Height for up to 25% more storage space



Build Green. Everyone Profits.

LEED- Leadership in Energy & Environmental Design

Legacy BuildingSM 848 has been constructed as a LEED[®] certified building. LEED[®] developments are voluntary and are designed to be environmentally responsible, high performing, sustainable and healthy places to work.

*LEED is a registered trademark of the U.S. Green Building Council.

Legacy BuildingSM 848

8975 Remington Avenue, Chino, CA

SPECIFICATIONS

BUILDING SIZE: 565,925 SF

OFFICE SIZE: 10,958 SF
(includes finished mezzanine)

LAND SIZE: 1,480,893 SF

TRUCK POSITIONS: Dock high: 107 (9'x 10')
Ground level ramp: 3 (12'x 15')
Cross-dock loading

TRUCK TURNING RADIUS: 185'

MINIMUM CLEARANCE: 36'

SPRINKLER SYSTEM: ESFR (K 25.2 heads)

TRAILER STORAGE SPACES: 140

POWER: 4,000 amps, 277/480 volts,
3 phase, 4 wire

WAREHOUSE LIGHTING: LED with motion
sensors

AUTO PARKING SPACES: 307

LEGACY FEATURES

6 1/2" thick, reinforced,
100% concrete truck courts

3% skylights

Architectural two-story glass entries

8" thick, reinforced, 4,000 psi
concrete floor slabs

Abundant clerestory glass

White scrim foil



WATSON

INDUSTRIAL PARK CHINO

565,925 SF

Available For Lease

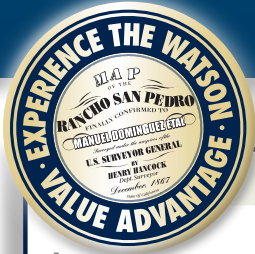

OFFICE PLAN 10,958 Total SF

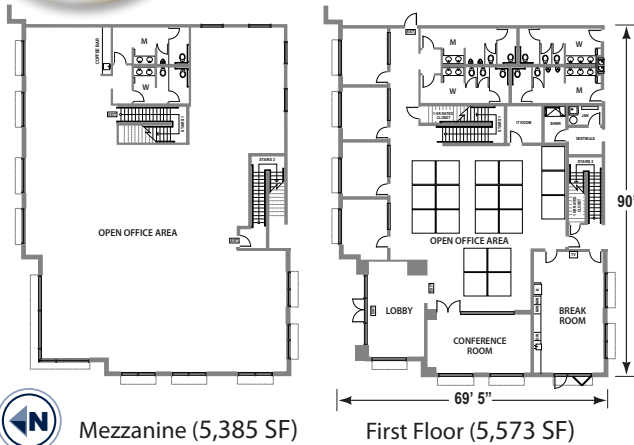

WATSON INDUSTRIAL PARK CHINO

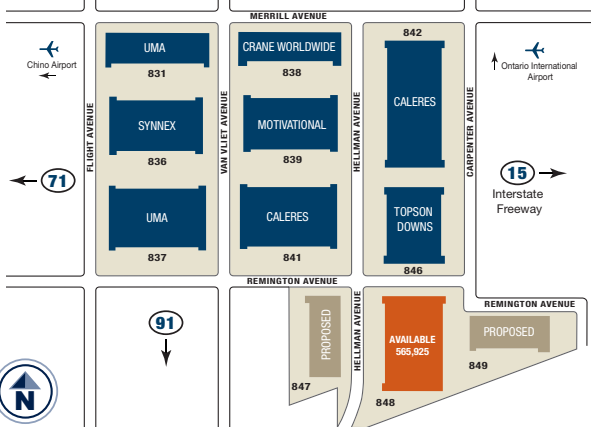

LEGACY BUILDINGSM 848 SITE PLAN

LEED[®] Certified

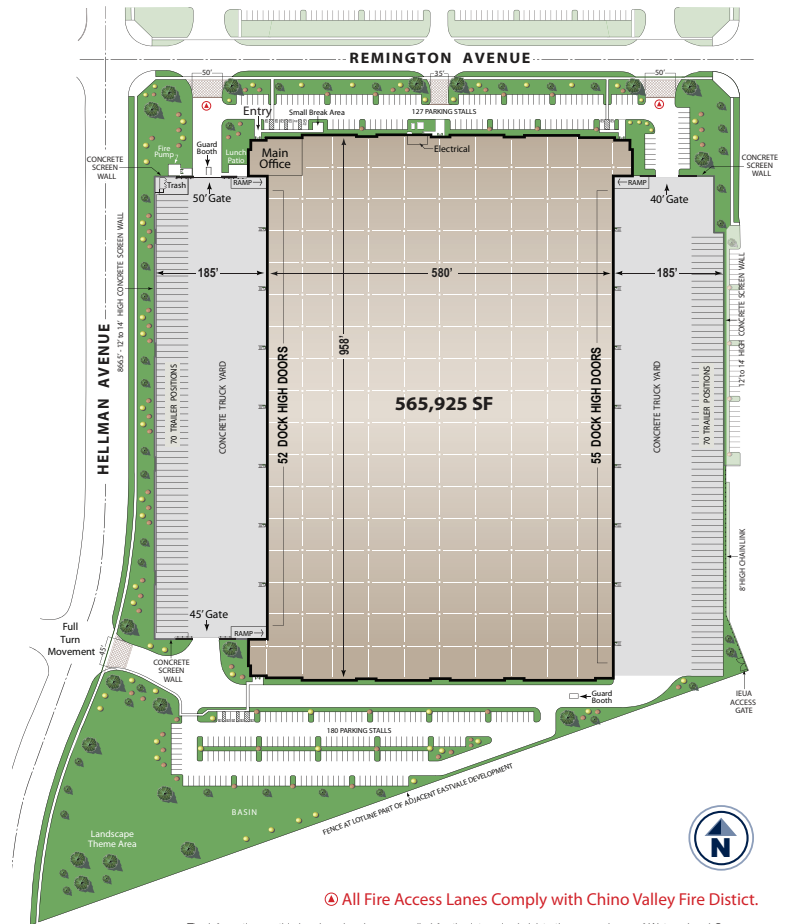

Ⓢ All Fire Access Lanes Comply with Chino Valley Fire District.

The information on this brochure has been compiled for the internal administrative convenience of Watson Land Company. Watson Land Company makes no representation or warranty, express or implied, as to the accuracy of this brochure. This brochure may not reflect all building improvements or as-built conditions. The information contained herein and on any other materials with which it is presented is not an offer and is subject to change without notice. Tenants should make their own independent investigations of all facts and assumptions on which they might rely in making a decision to lease property from Watson Land Company.



For Further Information Please Contact:

Bill Heim

bheim@lee-assoc.com

CalDRE : 00776174

Michael Chavez

mchavez@lee-assoc.com

CalDRE : 00929693

p 909.989.7771



Lee & Associates
3535 Inland Empire Blvd.
Ontario, CA 91761
lee-assoc.com

watsonipc.com