

DOMINGUEZ

TECHNOLOGY CENTER

290,034 SF

Available For Lease



Legacy BuildingSM 716

18120 Bishop Avenue, Carson, CA

VALUE ADVANTAGE

- Lower energy costs
- 25% more cubic storage than a 24' clear building
- Full concrete truck yard
- Potential merchandise processing fee savings with Foreign Trade Zone 202 activation
- Master Planned Center
- Close to Ports of Los Angeles, Long Beach and Los Angeles International Airport
- Convenient access to the San Diego (405), Harbor (110), Long Beach (710), Artesia (91) and Terminal Island (103) Frwys.
- Near Intermodal Container Transfer Facility

SPECIFICATIONS

BUILDING SIZE: 290,034 SF

OFFICE SIZE: Main Office 5,694 SF
(Mezzanine 5,149 SF)

LAND SIZE: 707,689 SF

POWER: 1,200 amps, Expandable to 3,000 amps, 277/480 volts, 3 phase, 4 wire

WAREHOUSE LIGHTING: T-5

SPRINKLER SYSTEM: ESFR

PARKING SPACES: 294

SKYLIGHTS: 3%

MINIMUM CLEARANCE: 32'

TURNING RADIUS: 185'

DOCK HIGH TRUCK POSITIONS: 65 - 9' x 10'
a) Twenty Two (22) 25,000 lb pit mounted load levelers
b) Nine (9) 35,000 lb pit mounted load levelers
c) Thirty Four (34) edge of dock levelers

GROUND LEVEL RAMP: 1 - 12' X 14'

BAY SPACING: 60' x 52' (Typical)
60' first bay from loading doors



DOMINGUEZ TECHNOLOGY CENTER

290,034 SF

Available For Lease

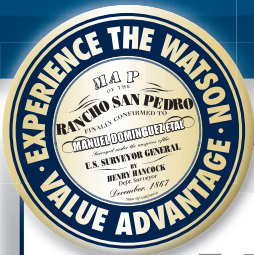

MAIN OFFICE : 10,843 SF

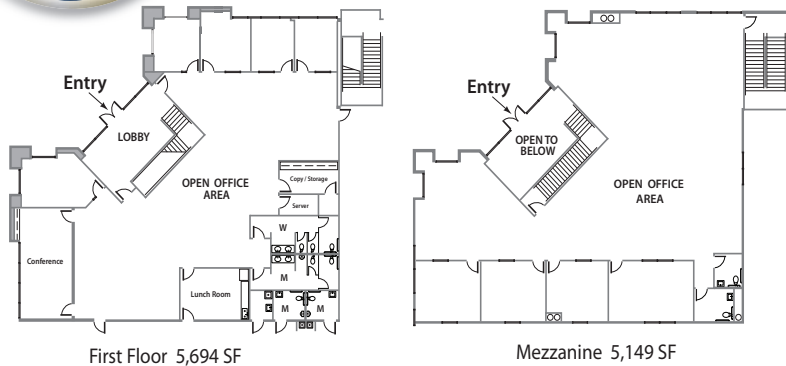

First Floor 5,694 SF

Mezzanine 5,149 SF

WAREHOUSE OFFICES

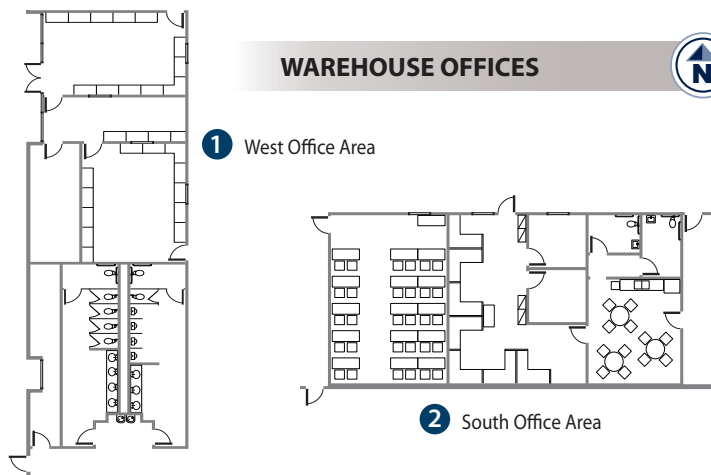

1 West Office Area

2 South Office Area

LEGACY BUILDINGSM 716 SITE PLAN

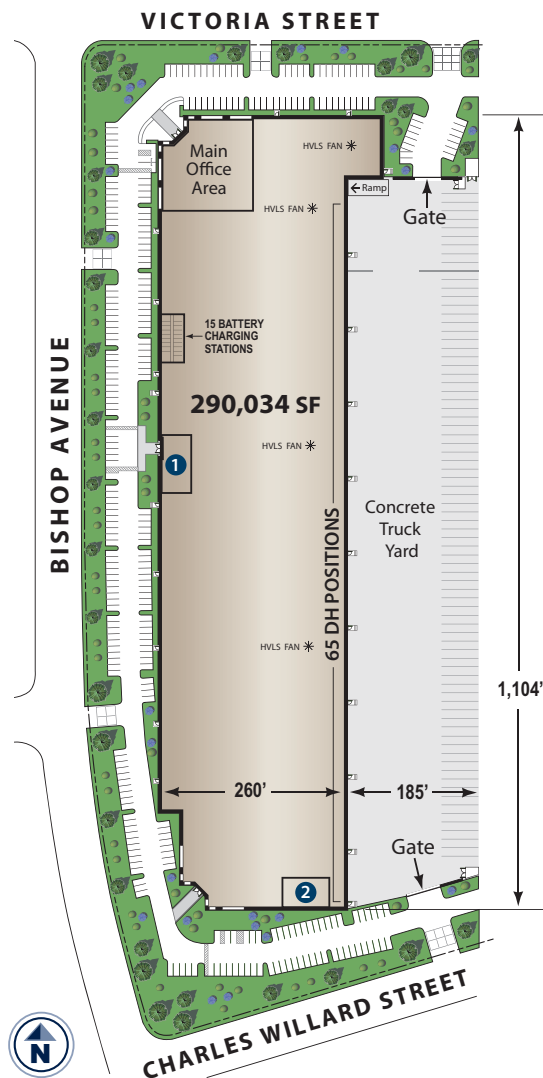

The information on this brochure has been compiled for the internal administrative convenience of Watson Land Company. Watson Land Company makes no representation or warranty, express or implied, as to the accuracy of this brochure. This brochure may not reflect all building improvements or as-built conditions. The information contained herein and on any other materials with which it is presented is not an offer and is subject to change without notice. Tenants should make their own independent investigations of all facts and assumptions on which they might rely in making a decision to lease property from Watson Land Company.



Lance Ryan
lryan@watsonlandcompany.com

Mike Bodlovich
mbodlovich@watsonlandcompany.com

Phone 310.952.6401
Fax 310.522.8788

